



**Please ask for:** Mrs J Hunt  
**Extension No:** 4623  
**E-mail:** [joannahunt@cannockchasedc.gov.uk](mailto:joannahunt@cannockchasedc.gov.uk)

31 January 2025

Dear Councillor,

**Licensing Sub-Committee**

**10:00am on Monday 10 February 2025**

**Meeting to be held in the Council Chamber, Civic Centre, Cannock**

You are invited to attend this meeting for consideration of the matters itemised in the following Agenda.

Yours sincerely,

**T. Clegg**  
**Chief Executive**

To: Councillors:

Fitzgerald, A.  
Jones, V.  
Wilson, L.  
Elson, J. (Reserve)

# **Agenda**

## **Part 1**

### **1. Appointment of Chair**

### **2. Apologies and Reconstitution of Membership**

The Council will only allow licensing decisions to be taken by a minimum of three Councillors.

In the event of one Member being unable to attend, their place will be substituted by another Member taken from the membership of the full Licensing and Public Protection Committee.

In the event of this substitution taking place, all parties will be informed of the change of membership at the beginning of the hearing.

### **3. Declarations of Interests of Members in Contracts and Other Matters and Restriction on Voting by Members**

To declare any personal, pecuniary, or disclosable pecuniary interests in accordance with the Code of Conduct and any possible contraventions under Section 106 of the Local Government Finance Act 1992.

### **4. Licensing Act 2003 - Application for a Premises Licence: Tower Garage Service Station, Brindley Road, Cannock, WS12 4LL**

Report of the Head of Regulatory Services (Enclosure 4.1 - 4.66).

**Cannock Chase Council**  
**Licensing Sub-Committee**

**Procedure to be used for a Premises Licence Application Submitted  
under the Licensing Act 2003**

**Procedure for the Hearing**

1. The Chair shall introduce the Members of the Sub-Committee and supporting staff.
2. All other parties present shall introduce themselves.
3. The Chair shall outline the procedure to be followed at the hearing and also make reference to the fact that each party has an equal amount of time within which to present their case and may set down limits for this.
4. The Officer representing the Licensing Authority shall present a report on the matter to be heard.
5. Any objectors to the application shall have the opportunity to ask questions of the Officer of the Licensing Authority.
6. The Applicant (or their representative) shall have the opportunity to ask questions of the Officer from the Licensing Authority.
7. Members of the Sub-Committee may ask questions of the Officer of the Licensing Authority.
8. *(Where the Officer of the Licensing Authority is legally represented, the legal representative may ask questions of clarification of the Officer of the Licensing Authority.)*
9. The Applicant (or their representative) shall put their case in respect of the matter and may call witnesses.
10. Any objectors to the application shall have the opportunity to ask questions of the Applicant (or their representative).
11. Members of the Sub-Committee may ask questions of clarification of the Applicant (or their representative) and any witnesses called.
12. **Anyone making representations** in respect of the application shall put their case in respect of the matter in the presence of the Officer representing the Licensing Authority and the Applicant and may call witnesses.
13. The Applicant (or their representative) may ask questions of clarification of anyone making representations and any witnesses called.

14. Members of the Sub-Committee may ask questions of clarification of anyone making representations and any witnesses called.
15. The Officer of the Licensing Authority shall have the opportunity to sum up their case if they so wish.
16. The Applicant (or their representative) shall have the opportunity to sum up their case if they so wish.
17. Any objectors to the application shall have the opportunity to sum up their respective cases if they so wish.
18. Members of the Sub-Committee shall deliberate in private, accompanied by the Council's Legal Advisor and the Secretary to the Sub-Committee, only recalling the other parties or their representatives to clarify points of uncertainty on evidence or submissions already given.

If it is necessary to recall any party, all parties are to return, notwithstanding that only one party may be concerned with the points giving rise to doubt.

19. At the conclusion of their deliberations, the Chair of the Sub-Committee may inform the Applicant (or their representative) of the decision of the Sub-Committee, briefly explaining the reasons for the decision.
20. The Applicant shall be written to **within seven working days** (or as soon as practicable if this cannot be completed) with confirmation of the Sub-Committee's decision and reasons for that decision.
21. The Applicant or any objector may appeal to the Magistrates Court within 21 days of the decision being received if they are dissatisfied with the Sub-Committee's decision.

**CANNOCK CHASE DISTRICT COUNCIL****LICENSING SUB COMMITTEE****REPORT OF THE HEAD OF REGULATORY SERVICES****LICENSING ACT 2003****APPLICATION FOR A PREMISES LICENCE - MONDAY 10<sup>TH</sup> FEBRUARY 2025 AT 10.00AM****TOWER GARAGE, BRINDLEY ROAD, HEDNESFORD, CANNOCK, WS12 4LL****1. Reason for Hearing**

This is an application for a Premises Licence by Tower Garage Service Station Ltd.

This application has not been granted under Officers' delegated powers because representations have been received from members of the public on the basis that they are concerned that the licensing objectives may be compromised if the premises licence application were granted. These are relevant representations and the Council, as the licensing authority, must therefore hold a hearing to consider the representations made. A copy of the application form is attached to this report as Annex 1.

**2.**

Name and Address of Premises.	Convenience Store - Tower Garage Brindley Road Hednesford Cannock WS12 4LL
Applicant Details Registered Address.	Tower Garage Service Station Ltd, Albany House Temple Court Temple Way Coleshill Warwickshire B46 1HH
Date of Application	20 December 2024
Fees Paid	Band B: £190.00

Licensable Activities Applied For:	<ol style="list-style-type: none"> <li>1. Supply of alcohol</li> <li>2. Late Night Refreshment</li> </ol>
Responsible Authority Representations	No formal representations have been received from any Responsible Authority.
Representations from other persons	<p>During the 28-day consultation period, 22 individual relevant representations were received with contact details provided as required.</p> <p>Of these:</p> <ul style="list-style-type: none"> <li>• 5 were original written email representations (these are attached to the report as Annex 2)</li> <li>• 5 other email representations contained the same information that appeared to have been copy &amp; pasted. (An example of these emails is attached to the report as Annex 3)</li> <li>• 2 were original written letters of representation (these are attached to the report as Annex 4)</li> <li>• 10 other letters of representation received contained the same information that appeared to have been a photocopied but had facility for a name and contact details to be added (An example of these letters is attached to the report as Annex 5)</li> </ul> <p>In addition to the representations, a petition was also received from a nearby General Convenience Store containing 983 signatures. The details of the person submitting the document were provided. (A copy of the petition is attached to this report as Annex 6).</p>

### 3. Matters for consideration

- 3.1 On 20 December 2024 an application was received from Tower Garage Service Station Ltd, for the grant of a Premises Licence under the Licensing Act 2003. The hours of operation requested on the licence application operating schedule are:

3.2 Hours premises are open to the public:

Monday to Sunday - 00.00hrs to 24.00hrs

3.3 Hours for late night refreshment

Monday to Sunday 23.00hrs to 05.00hrs

3.4 Hours for supply of alcohol:

Monday to Sunday - 00.00hrs to 24.00hrs

3.5 At Part 3 of the application that makes reference to the operating schedule, the applicant describes the premises as follows:

“This is a new ground floor food based Morrisons daily convenience store located on a forecourt serving local residents and workers and those from further afield including passing trade. Online / telephone orders will also be delivered and collected. The forecourt has been acquired by our clients and it is to be redeveloped under the Morrisons daily convenience format to produce a strong retail offer much as the several hundred licensed Morrisons. Forecourt stores across the country already trading.”

“The site will be operated by our clients who already own and operate other licensed convenience stores on their own forecourts and the off-licence facility is an important part of the service that such a store is now expected to provide. The DPS (Designated Premises Supervisor) will be responsible for training and authorising staff in the sale of alcohol with a full recorded training regime in place with 6 monthly refresher training and the DPS here will be varied to somebody who is in day to day to control of alcohol sales before any alcohol sales commence”

3.6 The application was duly advertised as required by law and the Council’s Licensing Unit received 22 valid letters or emails of objection and a petition against to the grant of the Premises Licence.

3.7 The applicant has stated that the name and details of the individual whom they wish to specify on the licence as the Designated Premises Supervisor (DPS) as being Mr. Christopher John Mitchener. The home address listed for the DPS is in Hampshire. Mr. Mitchener is the licensing agent of the applicant at today’s hearing.

As per 4.61 of the revised guidance issued under s182 Licensing Act 2003 (last updated Dec 2023)

‘4.61 Every premises licence that authorises the sale of alcohol must specify a DPS. This will normally be the person who has been given day to day responsibility for running the premises by the premises licence holder.’

#### **4. Human Rights Act 1998 Implications**

4.1 Article 6 of the Act provides that where a person’s civil rights and obligations are being determined, s/he is entitled to a “fair trial”. The Council complies with Article 6 in that it gives

the person the opportunity to state their case, will make a decision within a reasonable period of time and will give reasons for its decision.

- 4.2 The Article also provides for the issue to be determined by an independent tribunal. The right of appeal to the Magistrates' Court against the Council's decision fulfils this.
- 4.3 The Council observes the rules of natural justice, and its procedures are consistent with Article 6 of the Human Rights Act 1998.

## **5. Legal Implications**

- 5.1 This matter concerns an application for a premises licence under section 17 of the Licensing Act 2003 "the Act"
- 5.2 As relevant representations have been made in respect of this application and no agreement has been reached between the parties that a hearing is not required, the licensing authority must hold a hearing to consider the representations made (s.18 (3)(a) of the Act).
- 5.3 The Licensing Sub Committee must have regard to the representations and take such steps, if any, as it considers necessary for the promotion of the licensing objectives (s.18(3)(b) of the Act).
- 5.4 In accordance with s.18(4) of the Act, the steps that can be taken by the Licensing Sub Committee in dealing with this application are limited to:
  - (a) grant the premises licence, together with such modification of the conditions of the licence as considered appropriate for the promotion of the licensing objectives;
  - (b) rejection of the whole or part of the application.
- 5.5 The Licensing Sub Committee must only consider relevant representations which for the purposes of this application:
  - (a) are about the likely effect of the grant of the application on the promotion of the licensing objectives.
  - (b) are made by an interested party or responsible authority;
  - (c) have not been withdrawn; and
  - (d) are not frivolous or vexatious if made by other persons.
- 5.6 The Applicant and other persons who made relevant representations in relation to the application have a right of appeal to the Magistrates Court should they disagree with the Licensing Sub Committee's decision.

## **6. Financial Implications**

- 6.1 Fees for a premises licence are payable upon application. They are not refundable should the application be refused.
- 6.2 Should the application be refused or be granted subject to conditions; the Applicant has a right of appeal to the Magistrates' Court. Should the application be granted, with or without



conditions, then equally, the responsible authority and any other persons having made relevant representations, have a right of appeal to the Magistrates Court against the decision.

- 6.3 All appeals carry financial costs, and the Court can set whatever order it deems fit with regards to the payment of costs. The Court is, however, less likely to award costs against the Council if it is satisfied that the Council had acted honestly, reasonably and properly and on grounds which appear to be sound.

7. **Annexes**

Annexes Attached	Annex 1	The Premises Licence Application Form.
	Annex 2	5 relevant written email representations
	Annex 3	Example copy of 5 relevant representation emails that contained the same details that appeared to have been copy & pasted but were individually submitted with separate contact details
	Annex 4	2 valid written letters of representation
	Annex 5	Example copy of 10 letters, individually signed and addressed but containing same photocopied representation information.
	Annex 6	Petition from nearby General Convenience Store

**8. Determination**

Determination Required	<p>Members are asked to determine whether the application for a Premises Licence in respect of Tower Garage, can be granted, having due regard to the 4 Licensing Objectives, Cannock Chase Council's Licensing Policy and Guidance issued by the Secretary of State under s182 of the Licensing Act 2003.</p> <p>The 4 Licensing Objectives are:</p> <ul style="list-style-type: none"><li>• The Prevention of Crime &amp; Disorder</li><li>• Ensuring Public Safety</li><li>• The Prevention of Public Nuisance</li><li>• The Protection of Children from Harm</li></ul>
------------------------	--



**Cannock Chase**  
**Application for a premises licence**  
**Licensing Act 2003**

For help contact  
[licensingunit@cannockchasedc.gov.uk](mailto:licensingunit@cannockchasedc.gov.uk)  
 Telephone: 01543 464504

\* required information

### Section 1 of 21

You can save the form at any time and resume it later. You do not need to be logged in when you resume.

System reference  This is the unique reference for this application generated by the system.

Your reference  You can put what you want here to help you track applications if you make lots of them. It is passed to the authority.

Are you an agent acting on behalf of the applicant?

Yes  No

Put "no" if you are applying on your own behalf or on behalf of a business you own or work for.

#### Applicant Details

\* First name

\* Family name

\* E-mail

Main telephone number  Include country code.

Other telephone number

Indicate here if the applicant would prefer not to be contacted by telephone

Is the applicant:

Applying as a business or organisation, including as a sole trader

Applying as an individual

A sole trader is a business owned by one person without any special legal structure. Applying as an individual means the applicant is applying so the applicant can be employed, or for some other personal reason, such as following a hobby.

#### Applicant Business

Is the applicant's business registered in the UK with Companies House?  Yes  No

Note: completing the Applicant Business section is optional in this form.

Registration number

Business name  If the applicant's business is registered, use its registered name.

VAT number   Put "none" if the applicant is not registered for VAT.

Legal status

*Continued from previous page...*

Applicant's position in the business

Home country  The country where the applicant's headquarters are.

**Registered Address** Address registered with Companies House.

Building number or name

Street

District

City or town

County or administrative area

Postcode

Country

**Agent Details**

\* First name

\* Family name

\* E-mail

Main telephone number  Include country code.

Other telephone number

Indicate here if you would prefer not to be contacted by telephone

Are you:

An agent that is a business or organisation, including a sole trader A sole trader is a business owned by one person without any special legal structure.

A private individual acting as an agent

**Agent Business**

Is your business registered in the UK with Companies House?  Yes  No Note: completing the Applicant Business section is optional in this form.

Is your business registered outside the UK?  Yes  No

Business name  If your business is registered, use its registered name.

VAT number   Put "none" if you are not registered for VAT.

Legal status

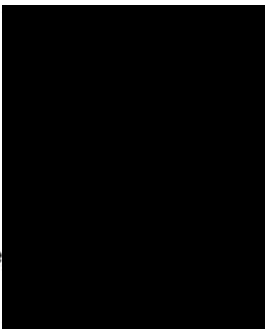
<i>Continued from previous page...</i>	
Your position in the business	OWNER
Home country	United Kingdom
The country where the headquarters of your business is located.	
<b>Agent Business Address</b>	
Building number or name	
Street	
District	
City or town	
County or administrative area	
Postcode	
Country	
If you have one, this should be your official address - that is an address required of you by law for receiving communications.	
<b>Section 2 of 21</b>	
<b>PREMISES DETAILS</b>	
I/we, as named in section 1, apply for a premises licence under section 17 of the Licensing Act 2003 for the premises described in section 2 below (the premises) and I/we are making this application to you as the relevant licensing authority in accordance with section 12 of the Licensing Act 2003.	
<b>Premises Address</b>	
Are you able to provide a postal address, OS map reference or description of the premises?	
<input checked="" type="radio"/> Address <input type="radio"/> OS map reference <input type="radio"/> Description	
<b>Postal Address Of Premises</b>	
Building number or name	CONVENIENCE STORE - TOWER GARAGE
Street	BRINDLEY ROAD
District	HEDNESFORD
City or town	CANNOCK
County or administrative area	
Postcode	WS12 4LL
Country	United Kingdom
<b>Further Details</b>	
Telephone number	
Non-domestic rateable value of premises (£)	9,500

Section 3 of 21	
<b>APPLICATION DETAILS</b>	
In what capacity are you applying for the premises licence?	
<input type="checkbox"/> An individual or individuals <input checked="" type="checkbox"/> A limited company / limited liability partnership <input type="checkbox"/> A partnership (other than limited liability) <input type="checkbox"/> An unincorporated association <input type="checkbox"/> Other (for example a statutory corporation) <input type="checkbox"/> A recognised club <input type="checkbox"/> A charity <input type="checkbox"/> The proprietor of an educational establishment <input type="checkbox"/> A health service body <input type="checkbox"/> A person who is registered under part 2 of the Care Standards Act 2000 (c14) in respect of an independent hospital in Wales <input type="checkbox"/> A person who is registered under Chapter 2 of Part 1 of the Health and Social Care Act 2008 in respect of the carrying on of a regulated activity (within the meaning of that Part) in an independent hospital in England <input type="checkbox"/> The chief officer of police of a police force in England and Wales	
<b>Confirm The Following</b>	
<input checked="" type="checkbox"/> I am carrying on or proposing to carry on a business which involves the use of the premises for licensable activities <input type="checkbox"/> I am making the application pursuant to a statutory function <input type="checkbox"/> I am making the application pursuant to a function discharged by virtue of His Majesty's prerogative	
Section 4 of 21	
<b>NON INDIVIDUAL APPLICANTS</b>	
Provide name and registered address of applicant in full. Where appropriate give any registered number. In the case of a partnership or other joint venture (other than a body corporate), give the name and address of each party concerned.	
<b>Non Individual Applicant's Name</b>	
Name	TOWER GARAGE SERVICE STATION LIMITED
<b>Details</b>	
Registered number (where applicable)	16038678
Description of applicant (for example partnership, company, unincorporated association etc)	

<i>Continued from previous page...</i>	
LIMITED COMPANY	
<b>Address</b>	
Building number or name	ALBANY HOUSE TEMPLE COURT
Street	TEMPLE WAY
District	
City or town	COLESHILL
County or administrative area	WARWICKSHIRE
Postcode	B46 1HH
Country	United Kingdom
<b>Contact Details</b>	
E-mail	
Telephone number	
Other telephone number	
* Date of birth	
	dd mm yyyy
* Nationality	BRITISH
	<a href="#">Documents that demonstrate entitlement to work in the UK</a>
<input type="button" value="Add another applicant"/>	
<b>Section 5 of 21</b>	
<b>OPERATING SCHEDULE</b>	
When do you want the premises licence to start?	<input type="text" value="18"/> / <input type="text" value="01"/> / <input type="text" value="2025"/>
	dd mm yyyy
If you wish the licence to be valid only for a limited period, when do you want it to end	<input type="text"/> / <input type="text"/> / <input type="text"/>
	dd mm yyyy
Provide a general description of the premises	
For example the type of premises, its general situation and layout and any other information which could be relevant to the licensing objectives. Where your application includes off-supplies of alcohol and you intend to provide a place for consumption of these off- supplies you must include a description of where the place will be and its proximity to the premises.	
THIS IS A NEW GROUND FLOOR FOOD BASED MORRISONS DAILY CONVENIENCE STORE LOCATED ON A FORECOURT SERVING LOCAL RESIDENTS AND WORKERS AND THOSE FROM FURTHER AFIELD INCLUDING PASSING TRADE. ONLINE / TELEPHONE ORDERS WILL ALSO BE DELIVERED AND COLLECTED. THE FORECOURT HAS BEEN ACQUIRED BY OUR CLIENTS AND IT IS TO BE REDEVELOPED UNDER THE MORRISONS DAILY CONVENIENCE FORMAT TO PRODUCE A STRONG RETAIL OFFER MUCH AS THE SEVERAL HUNDRED LICENSED MORRISONS	

<p><i>Continued from previous page...</i></p> <p>FORECOURT STORES ACROSS THE COUNTRY ALREADY TRADING.          THE SITE WILL BE OPERATED BY OUR CLIENTS WHO ALREADY OWN AND OPERATE OTHER LICENSED CONVENIENCE STORES ON THEIR OWN FORECOURTS AND THE OFF LICENCE FACILITY IS AN IMPORTANT PART OF THE SERVICE THAT SUCH A STORE IS NOW EXPECTED TO PROVIDE.          THE DPS WILL BE RESPONSIBLE FOR TRAINING AND AUTHORISING STAFF IN THE SALE OF ALCOHOL WITH A FULL RECORDED TRAINING REGIME IN PLACE WITH 6 MONTHLY REFRESHER TRAINING AND THE DPS HERE WILL BE VARIED TO SOMEBODY WHO IS IN DAY TO DAY TO CONTROL OF ALCOHOL SALES BEFORE ANY ALCOHOL SALES COMMENCE</p>
<p>If 5,000 or more people are expected to attend the premises at any one time, state the number expected to attend <input type="text"/></p>
<p><b>Section 6 of 21</b></p>
<p><b>PROVISION OF PLAYS</b></p>
<p><a href="#">See guidance on regulated entertainment</a></p>
<p>Will you be providing plays?</p> <p><input type="radio"/> Yes <input checked="" type="radio"/> No</p>
<p><b>Section 7 of 21</b></p>
<p><b>PROVISION OF FILMS</b></p>
<p><a href="#">See guidance on regulated entertainment</a></p>
<p>Will you be providing films?</p> <p><input type="radio"/> Yes <input checked="" type="radio"/> No</p>
<p><b>Section 8 of 21</b></p>
<p><b>PROVISION OF INDOOR SPORTING EVENTS</b></p>
<p><a href="#">See guidance on regulated entertainment</a></p>
<p>Will you be providing indoor sporting events?</p> <p><input type="radio"/> Yes <input checked="" type="radio"/> No</p>
<p><b>Section 9 of 21</b></p>
<p><b>PROVISION OF BOXING OR WRESTLING ENTERTAINMENTS</b></p>
<p><a href="#">See guidance on regulated entertainment</a></p>
<p>Will you be providing boxing or wrestling entertainments?</p> <p><input type="radio"/> Yes <input checked="" type="radio"/> No</p>
<p><b>Section 10 of 21</b></p>
<p><b>PROVISION OF LIVE MUSIC</b></p>
<p><a href="#">See guidance on regulated entertainment</a></p>
<p>Will you be providing live music?</p> <p><input type="radio"/> Yes <input checked="" type="radio"/> No</p>
<p><b>Section 11 of 21</b></p>
<p><b>PROVISION OF RECORDED MUSIC</b></p>
<p><a href="#">See guidance on regulated entertainment</a></p>



<i>Continued from previous page...</i>	
Will you be providing recorded music?	
<input type="radio"/> Yes	<input checked="" type="radio"/> No
<b>Section 12 of 21</b>	
<b>PROVISION OF PERFORMANCES OF DANCE</b>	
<a href="#">See guidance on regulated entertainment</a>	
Will you be providing performances of dance?	
<input type="radio"/> Yes	<input checked="" type="radio"/> No
<b>Section 13 of 21</b>	
<b>PROVISION OF ANYTHING OF A SIMILAR DESCRIPTION TO LIVE MUSIC, RECORDED MUSIC OR PERFORMANCES OF DANCE</b>	
<a href="#">See guidance on regulated entertainment</a>	
Will you be providing anything similar to live music, recorded music or performances of dance?	
<input type="radio"/> Yes	<input checked="" type="radio"/> No
<b>Section 14 of 21</b>	
<b>LATE NIGHT REFRESHMENT</b>	
Will you be providing late night refreshment?	
<input checked="" type="radio"/> Yes	<input type="radio"/> No
<b>Standard Days And Timings</b>	
MONDAY	
Start <input type="text" value="00:00"/>	End <input type="text" value="05:00"/>
Start <input type="text" value="23:00"/>	End <input type="text" value="24:00"/>
TUESDAY	
Start <input type="text" value="00:00"/>	End <input type="text" value="05:00"/>
Start <input type="text" value="23:00"/>	End <input type="text" value="24:00"/>
WEDNESDAY	
Start <input type="text" value="00:00"/>	End <input type="text" value="05:00"/>
Start <input type="text" value="23:00"/>	End <input type="text" value="24:00"/>
THURSDAY	
Start <input type="text" value="00:00"/>	End <input type="text" value="05:00"/>
Start <input type="text" value="23:00"/>	End <input type="text" value="24:00"/>
FRIDAY	
Start <input type="text" value="00:00"/>	End <input type="text" value="05:00"/>
Start <input type="text" value="23:00"/>	End <input type="text" value="24:00"/>

Give timings in 24 hour clock.  
(e.g., 16:00) and only give details for the days  
of the week when you intend the premises  
to be used for the activity.

*Continued from previous page...*

SATURDAY

Start

End

Start

End

SUNDAY

Start

End

Start

End

Will the provision of late night refreshment take place indoors or outdoors or both?

- Indoors       Outdoors       Both

Where taking place in a building or other structure tick as appropriate. Indoors may include a tent.

State type of activity to be authorised, if not already stated, and give relevant further details, for example (but not exclusively) whether or not music will be amplified or unamplified.

HOT FOOD AND DRINKS IN A FOOD TO GO CONCEPT

State any seasonal variations

For example (but not exclusively) where the activity will occur on additional days during the summer months.

Non-standard timings. Where the premises will be used for the supply of late night refreshments at different times from those listed in the column on the left, list below

For example (but not exclusively), where you wish the activity to go on longer on a particular day e.g. Christmas Eve.

**Section 15 of 21**

**SUPPLY OF ALCOHOL**

Will you be selling or supplying alcohol?

- Yes       No

**Standard Days And Timings**

*Continued from previous page...*

MONDAY

Start

End

Start

End

Give timings in 24 hour clock.  
(e.g., 16:00) and only give details for the days  
of the week when you intend the premises  
to be used for the activity.

TUESDAY

Start

End

Start

End

WEDNESDAY

Start

End

Start

End

THURSDAY

Start

End

Start

End

FRIDAY

Start

End

Start

End

SATURDAY

Start

End

Start

End

SUNDAY

Start

End

Start

End

Will the sale of alcohol be for consumption:

- On the premises     Off the premises     Both

If the sale of alcohol is for consumption on  
the premises select on, if the sale of alcohol  
is for consumption away from the premises  
select off. If the sale of alcohol is for  
consumption on the premises and away  
from the premises select both.

State any seasonal variations

For example (but not exclusively) where the activity will occur on additional days during the summer months.

Non-standard timings. Where the premises will be used for the supply of alcohol at different times from those listed in the column on the left, list below

*Continued from previous page...*

For example (but not exclusively), where you wish the activity to go on longer on a particular day e.g. Christmas Eve.

State the name and details of the individual whom you wish to specify on the licence as premises supervisor

**Name**

First name

Family name

Date of birth

dd      mm      yyyy

**Enter the contact's address**

Building number or name

Street

District

City or town

County or administrative area

Postcode

Country

Personal Licence number (if known)

Issuing licensing authority (if known)

**PROPOSED DESIGNATED PREMISES SUPERVISOR CONSENT**

How will the consent form of the proposed designated premises supervisor be supplied to the authority?

- Electronically, by the proposed designated premises supervisor
- As an attachment to this application

Reference number for consent form (if known)

If the consent form is already submitted, ask the proposed designated premises supervisor for its 'system reference' or 'your reference'.

**Section 16 of 21**

**ADULT ENTERTAINMENT**

*Continued from previous page...*

Highlight any adult entertainment or services, activities, or other entertainment or matters ancillary to the use of the premises that may give rise to concern in respect of children

Give information about anything intended to occur at the premises or ancillary to the use of the premises which may give rise to concern in respect of children, regardless of whether you intend children to have access to the premises, for example (but not exclusively) nudity or semi-nudity, films for restricted age groups etc gambling machines etc.

NONE

**Section 17 of 21**

**HOURS PREMISES ARE OPEN TO THE PUBLIC**

**Standard Days And Timings**

MONDAY

Start

End

Start

End

TUESDAY

Start

End

Start

End

WEDNESDAY

Start

End

Start

End

THURSDAY

Start

End

Start

End

FRIDAY

Start

End

Start

End

SATURDAY

Start

End

Start

End

SUNDAY

Start

End

Start

End

Give timings in 24 hour clock. (e.g., 16:00) and only give details for the days of the week when you intend the premises to be used for the activity.

State any seasonal variations

For example (but not exclusively) where the activity will occur on additional days during the summer months.

*Continued from previous page...*

--

Non standard timings. Where you intend to use the premises to be open to the members and guests at different times from those listed in the column on the left, list below

For example (but not exclusively), where you wish the activity to go on longer on a particular day e.g. Christmas Eve.

--

#### Section 18 of 21

#### LICENSING OBJECTIVES

Describe the steps you intend to take to promote the four licensing objectives:

a) General – all four licensing objectives (b,c,d,e)

List here steps you will take to promote all four licensing objectives together.

FULL ALARM SYSTEM, EXTENSIVE CCTV SYSTEM WITH 28 DAY RECORDING FACILITIES WITH ACCESS BY THE POLICE AND RESPONSIBLE AUTHORITIES UPON REQUEST TO THE DPS OR HIS DELEGATE, TRAINED STAFF WITH RECORDED INITIAL ALCOHOL TRAINING REGIME AND ONGOING 6 MONTHLY RECORDED REFRESHER TRAINING COPIES OF WHICH TO BE MADE AVAILABLE TO THE RESPONSIBLE AUTHORITIES OR THE POLICE UPON REQUEST TO THE DPS OR HIS DELEGATE, CHALLENGE 25 AND PROOF OF AGE INITIATIVE TO BE APPLIED TO ANY CUSTOMERS WHO APPEAR TO BE UNDER THE AGE OF 25, SUPPORTED BY FULL RECORDED STAFF TRAINING AND INSTORE CHALLENGE SIGNAGE, REFUSALS SYSTEM WITH REFUSALS BOOK OR COMPUTERISED TILL SYSTEM TO BE UTILISED TO RECORD ALL ALCOHOL REFUSALS TO BE MADE AVAILABLE TO THE RESPONSIBLE AUTHORITIES AND THE POLICE UPON REQUEST AND COPY KEPT FOR 12 MONTHS, AND A SEPARATE INCIDENT LOG TO BE MAINTAINED AND MADE AVAILABLE TO THE RESPONSIBLE AUTHORITIES OR THE POLICE UPON REQUEST TO THE DPS OR HIS DELEGATE, NO BEERS LAGERS OR CIDERS ABOVE 6% ABV TO BE SOLD OR SUPPLIED FROM THE PREMISES IN CANS OR PET/PLASTIC BOTTLES, THIS PROHIBITION SHALL NOT APPLY TO PREMIUM BEER, LAGER OR CIDER WITH AN ABV ABOVE 6% SUCH AS CRAFT OR SPECIALITY BRANDS, BRANDS PRODUCED BY MICRO BREWERIES OR BRANDS PRODUCED TO COMMEMORATE A NATIONAL OR LOCAL EVENT, TILL PROMPTS TO BE UTILISED FOR ALCOHOL PRODUCTS TO AVOID UNDER AGE SALES, ALL ONLINE/TELEPHONE DELIVERED AND COLLECTED SALES TO FOLLOW A SET PROCEDURE TO ENSURE THAT ANY ORDER PLACED IS MADE BY AND RECEIVED BY CUSTOMERS AGED OVER 18 AND ONLY DELIVERED TO PROPER ADDRESSES OR THE ORDER AND OR DELIVERY IS TO BE REFUSED.

b) The prevention of crime and disorder

ALARM SYSTEM, CCTV SYSTEM WITH RECORDING FACILITY, TRAINED STAFF, CHALLENGE 25, REFUSALS SYSTEM AND INCIDENT LOG, SIGNAGE REQUESTING CUSTOMERS TO RESPECT OUR NEIGHBOURS

c) Public safety

STAFF TRAINED IN FIRE SAFETY PROCEDURES AND THE USE OF FIRE SAFETY EQUIPMENT, FIRE FIGHTING EQUIPMENT AVAILABLE

d) The prevention of public nuisance

*Continued from previous page...*

STAFF TRAINED TO DEAL WITH SITUATIONS , CCTV, NOTICES REQUESTING CUSTOMERS TO LEAVE THE FORECOURT QUIETLY, USEABLE WASTE RECEPTACLES TO BE MAINTAINED ON THE FORECOURT

e) The protection of children from harm

FULL ALCOHOL TRAINING REGIME IN USE WITH RECORDED ALCOHOL TRAINING AND ONGOING RECORDED REFRESHER TRAINING TO BE CARRIED OUT EVERY SIX MONTHS, CHALLENGE 25 TRADING INITIATIVE EMBRACED, CHALLENGE SIGNAGE, REFUSALS SYSTEM AND REFUSALS BOOK AND CCTV COVERAGE

**Section 19 of 21**

**NOTES ON DEMONSTRATING ENTITLEMENT TO WORK IN THE UK**

*Continued from previous page...*

**Entitlement to work/immigration status for individual applicants and applications from partnerships which are not limited liability partnerships:**

A licence may not be held by an individual or an individual in a partnership who is resident in the UK who:

- does not have the right to live and work in the UK; or
- is subject to a condition preventing him or her from doing work relating to the carrying on of a licensable activity.

Any premises licence issued in respect of an application made on or after 6 April 2017 will become invalid if the holder ceases to be entitled to work in the UK.

Applicants must demonstrate that they have an entitlement to work in the UK and are not subject to a condition preventing them from doing work relating to the carrying on of a licensable activity. They do this in one of two ways: 1) by providing with this application copies or scanned copies of the documents listed below (which do not need to be certified), or 2) by providing their 'share code' to enable the licensing authority to carry out a check using the Home Office online right to work checking service (see below).

**Documents which demonstrate entitlement to work in the UK**

- An expired or current passport showing the holder, or a person named in the passport as the child of the holder, is a British citizen or a citizen of the UK and Colonies having the right of abode in the UK [please see note below about which sections of the passport to copy].
- An expired or current passport or national identity card showing the holder, or a person named in the passport as the child of the holder, is a national of a European Economic Area country or Switzerland.
- A Registration Certificate or document certifying permanent residence issued by the Home Office to a national of a European Economic Area country or Switzerland.
- A Permanent Residence Card issued by the Home Office to the family member of a national of a European Economic Area country or Switzerland.
- A **current** Biometric Immigration Document (Biometric Residence Permit) issued by the Home Office to the holder indicating that the person named is allowed to stay indefinitely in the UK, or has no time limit on their stay in the UK.
- A **current** passport endorsed to show that the holder is exempt from immigration control, is allowed to stay indefinitely in the UK, has the right of abode in the UK, or has no time limit on their stay in the UK.
- A **current** Immigration Status Document issued by the Home Office to the holder with an endorsement indicating that the named person is allowed to stay indefinitely in the UK or has no time limit on their stay in the UK, **when produced in combination with** an official document giving the person's permanent National Insurance number and their name issued by a Government agency or a previous employer.
- A birth or adoption certificate issued in the UK, **when produced in combination with** an official document giving the person's permanent National Insurance number and their name issued by a Government agency or a previous employer.
- A birth or adoption certificate issued in the Channel Islands, the Isle of Man or Ireland **when produced in combination with** an official document giving the person's permanent National Insurance number and their name issued by a Government agency or a previous employer.
- A certificate of registration or naturalisation as a British citizen, **when produced in combination with** an official document giving the person's permanent National Insurance number and their name issued by a Government agency or a previous employer.



*Continued from previous page...*

- A **current** passport endorsed to show that the holder is allowed to stay in the UK and is currently allowed to work and is not subject to a condition preventing the holder from doing work relating to the carrying on of a licensable activity.
- A **current** Biometric Immigration Document (Biometric Residence Permit) issued by the Home Office to the holder which indicates that the named person can currently stay in the UK and is allowed to work relation to the carrying on of a licensable activity.
- A **current** Residence Card issued by the Home Office to a person who is not a national of a European Economic Area state or Switzerland but who is a family member of such a national or who has derivative rights or residence.
- A **current** Immigration Status Document containing a photograph issued by the Home Office to the holder with an endorsement indicating that the named person may stay in the UK, and is allowed to work and is not subject to a condition preventing the holder from doing work relating to the carrying on of a licensable activity **when produced in combination with** an official document giving the person's permanent National Insurance number and their name issued by a Government agency or a previous employer.
- A Certificate of Application, **less than 6 months old**, issued by the Home Office under regulation 18(3) or 20(2) of the Immigration (European Economic Area) Regulations 2016, to a person who is not a national of a European Economic Area state or Switzerland but who is a family member of such a national or who has derivative rights of residence.
- Reasonable evidence that the person has an outstanding application to vary their permission to be in the UK with the Home Office such as the Home Office acknowledgement letter or proof of postage evidence, or reasonable evidence that the person has an appeal or administrative review pending on an immigration decision, such as an appeal or administrative review reference number.
- Reasonable evidence that a person who is not a national of a European Economic Area state or Switzerland but who is a family member of such a national or who has derivative rights of residence in exercising treaty rights in the UK including:-
  - evidence of the applicant's own identity – such as a passport,
  - evidence of their relationship with the European Economic Area family member – e.g. a marriage certificate, civil partnership certificate or birth certificate, and
  - evidence that the European Economic Area national has a right of permanent residence in the UK or is one of the following if they have been in the UK for more than 3 months:
    - (i) working e.g. employment contract, wage slips, letter from the employer,
    - (ii) self-employed e.g. contracts, invoices, or audited accounts with a bank,
    - (iii) studying e.g. letter from the school, college or university and evidence of sufficient funds; or
    - (iv) self-sufficient e.g. bank statements.

Family members of European Economic Area nationals who are studying or financially independent must also provide evidence that the European Economic Area national and any family members hold comprehensive sickness insurance in the UK. This can include a private medical insurance policy, an EHIC card or an S1, S2 or S3 form.

**Original documents must not be sent to licensing authorities.** If the document copied is a passport, a copy of the following pages should be provided:-

- (i) any page containing the holder's personal details including nationality;
- (ii) any page containing the holder's photograph;
- (iii) any page containing the holder's signature;
- (iv) any page containing the date of expiry; and
- (v) any page containing information indicating the holder has permission to enter or remain in the UK and is permitted to work.

*Continued from previous page...*

If the document is not a passport, a copy of the whole document should be provided.

Your right to work will be checked as part of your licensing application and this could involve us checking your immigration status with the Home Office. We may otherwise share information with the Home Office. Your licence application will not be determined until you have complied with this guidance.

#### **Home Office online right to work checking service**

As an alternative to providing a copy of the documents listed above, applicants may demonstrate their right to work by allowing the licensing authority to carry out a check with the Home Office online right to work checking service.

To demonstrate their right to work via the Home Office online right to work checking service, applicants should include in this application their 9-digit share code (provided to them upon accessing the service at <https://www.gov.uk/prove-right-to-work>) which, along with the applicant's date of birth (provided within this application), will allow the licensing authority to carry out the check.

In order to establish the applicant's right to work, the check will need to indicate that the applicant is allowed to work in the United Kingdom and is not subject to a condition preventing them from doing work relating to the carrying on of a licensable activity.

An online check will not be possible in all circumstances because not all applicants will have an immigration status that can be checked online. The Home Office online right to work checking service sets out what information and/or documentation applicants will need in order to access the service. Applicants who are unable to obtain a share code from the service should submit copy documents as set out above.

**Section 20 of 21**

**NOTES ON REGULATED ENTERTAINMENT**

*Continued from previous page...*

In terms of specific **regulated entertainments** please note that:

- Plays: no licence is required for performances between 08:00 and 23.00 on any day, provided that the audience does not exceed 500.
- Films: no licence is required for 'not-for-profit' film exhibition held in community premises between 08.00 and 23.00 on any day provided that the audience does not exceed 500 and the organiser (a) gets consent to the screening from a person who is responsible for the premises; and (b) ensures that each such screening abides by age classification ratings.
- Indoor sporting events: no licence is required for performances between 08.00 and 23.00 on any day, provided that the audience does not exceed 1000.
- Boxing or Wrestling Entertainment: no licence is required for a contest, exhibition or display of Greco-Roman wrestling, or freestyle wrestling between 08.00 and 23.00 on any day, provided that the audience does not exceed 1000. Combined fighting sports – defined as a contest, exhibition or display which combines boxing or wrestling with one or more martial arts – are licensable as a boxing or wrestling entertainment rather than an indoor sporting event.
- Live music: no licence permission is required for:
  - o a performance of unamplified live music between 08.00 and 23.00 on any day, on any premises.
  - o a performance of amplified live music between 08.00 and 23.00 on any day on premises authorised to sell alcohol for consumption on those premises, provided that the audience does not exceed 500.
  - o a performance of amplified live music between 08.00 and 23.00 on any day, in a workplace that is not licensed to sell alcohol on those premises, provided that the audience does not exceed 500.
  - o a performance of amplified live music between 08.00 and 23.00 on any day, in a church hall, village hall, community hall, or other similar community premises, that is not licensed by a premises licence to sell alcohol, provided that (a) the audience does not exceed 500, and (b) the organiser gets consent for the performance from a person who is responsible for the premises.
  - o a performance of amplified live music between 08.00 and 23.00 on any day, at the non-residential premises of (i) a local authority, or (ii) a school, or (iii) a hospital, provided that (a) the audience does not exceed 500, and (b) the organiser gets consent for the performance on the relevant premises from: (i) the local authority concerned, or (ii) the school or (iii) the health care provider for the hospital.
- Recorded Music: no licence permission is required for:
  - o any playing of recorded music between 08.00 and 23.00 on any day on premises authorised to sell alcohol for consumption on those premises, provided that the audience does not exceed 500.
  - o any playing of recorded music between 08.00 and 23.00 on any day, in a church hall, village hall, community hall, or other similar community premises, that is not licensed by a premises licence to sell alcohol, provided that (a) the audience does not exceed 500, and (b) the organiser gets consent for the performance from a person who is responsible for the premises.
  - o any playing of recorded music between 08.00 and 23.00 on any day, at the non-residential premises of (i) a local authority, or (ii) a school, or (iii) a hospital, provided that (a) the audience does not exceed 500, and (b) the organiser gets consent for the performance on the relevant premises from: (i) the local authority concerned, or (ii) the school proprietor or (iii) the health care provider for the hospital.

**Continued from previous page...**

- Dance: no licence is required for performances between 08.00 and 23.00 on any day, provided that the audience does not exceed 500. However, a performance which amounts to adult entertainment remains licensable.
- Cross activity exemptions: no licence is required between 08.00 and 23.00 on any day, with no limit on audience size for:
  - o any entertainment taking place on the premises of the local authority where the entertainment is provided by or on behalf of the local authority;
  - o any entertainment taking place on the hospital premises of the health care provider where the entertainment is provided by or on behalf of the health care provider;
  - o any entertainment taking place on the premises of the school where the entertainment is provided by or on behalf of the school proprietor; and
  - o any entertainment (excluding films and a boxing or wrestling entertainment) taking place at a travelling circus, provided that (a) it takes place within a moveable structure that accommodates the audience, and (b) that the travelling circus has not been located on the same site for more than 28 consecutive days.

**Section 21 of 21****PAYMENT DETAILS**

This fee must be paid to the authority. If you complete the application online, you must pay it by debit or credit card.

Premises Licence Fees are determined by the non domestic rateable value of the premises.

To find out a premises non domestic rateable value go to the Valuation Office Agency site at [http://www.voa.gov.uk/business\\_rates/index.htm](http://www.voa.gov.uk/business_rates/index.htm) or [www.cannockchasedc.gov.uk](http://www.cannockchasedc.gov.uk).

Band A - No RV to £4300	£100.00
Band B - £4301 to £33000	£190.00
Band C - £33001 to £8700	£315.00
Band D - £87001 to £12500	£450.00*
Band E - £125001 and over	£635.00*

In addition to the application fee, a multiplier will be applied to town and city centre pubs (those in Bands D and E), where they are exclusively or primarily in the business of selling alcohol.

Band D £900

Band E £1,905

Band D - £87001 to £12500	£900.00
Band E - £125001 and over	£1,905.00

There is an exemption from the payment of fees in relation to the provision of regulated entertainment at church halls, chapel halls or premises of a similar nature, village halls, parish or community halls, or other premises of a similar nature. The costs associated with these licences will be met by central Government. If, however, the licence also authorises the use of the premises for the supply of alcohol or the provision of late night refreshment, a fee will be required.

Schools and sixth form colleges are exempt from the fees associated with the authorisation of regulated entertainment where the entertainment is provided by and at the school or college and for the purposes of the school or college.

If you operate a large event you are subject to ADDITIONAL fees based upon the number in attendance at any one time

Capacity 5000-9999	£1,000.00
Capacity 10000 -14999	£2,000.00
Capacity 15000-19999	£4,000.00
Capacity 20000-29999	£8,000.00

<b>Continued from previous page...</b>	
Capacity 30000-39000	£16,000.00
Capacity 40000-49999	£24,000.00
Capacity 50000-59999	£32,000.00
Capacity 60000-69999	£40,000.00
Capacity 70000-79999	£48,000.00
Capacity 80000-89999	£56,000.00
Capacity 90000 and over	£64,000.00
* Fee amount (£)	<input type="text" value="190.00"/>
<b>DECLARATION</b>	
<p>* I/we understand it is an offence, liable on conviction to a fine up to level 5 on the standard scale, under section 158 of the licensing act 2003, to make a false statement in or in connection with this application.</p> <p>* I have sent copies of this application and the plan to the responsible authorities and others where applicable</p> <p>* I understand that I must now advertise my application</p> <p><input checked="" type="checkbox"/> Ticking this box indicates you have read and understood the above declaration</p> <p>This section should be completed by the applicant, unless you answered "Yes" to the question "Are you an agent acting on behalf of the applicant?"</p> <p>* Full name <input type="text" value="CHRIS MITCHENER"/></p> <p>* Capacity <input type="text" value="DULY AUTHORISED AGENT"/></p> <p>* Date <input type="text" value="20"/> / <input type="text" value="12"/> / <input type="text" value="2024"/> dd mm yyyy</p>	
<input type="button" value="Add another signatory"/>	
<p>Once you're finished you need to do the following:</p> <ol style="list-style-type: none"> <li>1. Save this form to your computer by clicking file/save as...</li> <li>2. Go back to <a href="https://www.gov.uk/apply-for-a-licence/premises-licence/cannock-chase/apply-1">https://www.gov.uk/apply-for-a-licence/premises-licence/cannock-chase/apply-1</a> to upload this file and continue with your application.</li> </ol> <p>Don't forget to make sure you have all your supporting documentation to hand.</p>	
<p><b>IT IS AN OFFENCE LIABLE TO SUMMARY CONVICTION TO A FINE OF ANY AMOUNT UNDER SECTION 158 OF THE LICENSING ACT 2003, TO MAKE A FALSE STATEMENT IN OR IN CONNECTION WITH THIS APPLICATION</b></p> <p><b>IT IS AN OFFENCE UNDER SECTION 24B OF THE IMMIGRATION ACT 1971 FOR A PERSON TO WORK WHEN THEY KNOW, OR HAVE REASONABLE CAUSE TO BELIEVE, THAT THEY ARE DISQUALIFIED FROM DOING SO BY REASON OF THEIR IMMIGRATION STATUS. THOSE WHO EMPLOY AN ADULT WITHOUT LEAVE OR WHO IS SUBJECT TO CONDITIONS AS TO EMPLOYMENT WILL BE LIABLE TO A CIVIL PENALTY UNDER SECTION 15 OF THE IMMIGRATION, ASYLUM AND NATIONALITY ACT 2006 AND PURSUANT TO SECTION 21 OF THE SAME ACT, WILL BE COMMITTING AN OFFENCE WHERE THEY DO SO IN THE KNOWLEDGE, OR WITH REASONABLE CAUSE TO BELIEVE, THAT THE EMPLOYEE IS DISQUALIFIED</b></p>	

OFFICE USE ONLY	
Applicant reference number	<input type="text" value="Tower Garage 20 12 24"/>
Fee paid	<input type="text"/>
Payment provider reference	<input type="text"/>
ELMS Payment Reference	<input type="text"/>
Payment status	<input type="text"/>
Payment authorisation code	<input type="text"/>
Payment authorisation date	<input type="text"/>
Date and time submitted	<input type="text"/>
Approval deadline	<input type="text"/>
Error message	<input type="text"/>
Is Digitally signed	<input type="checkbox"/>

[1](#) [2](#) [3](#) [4](#) [5](#) [6](#) [7](#) [8](#) [9](#) [10](#) [11](#) [12](#) [13](#) [14](#) [15](#) [16](#) [17](#) [18](#) [19](#) [20](#) [21](#) [Next >](#)

**TOWER GARAGE SERVICE STATION Limited, Convenience Store, Brindley Road, Hednesford WS12 4LL**  
Shop Layout Scale 1:100 @ A4. 12/24/008 December 2024 Licensing Solutions

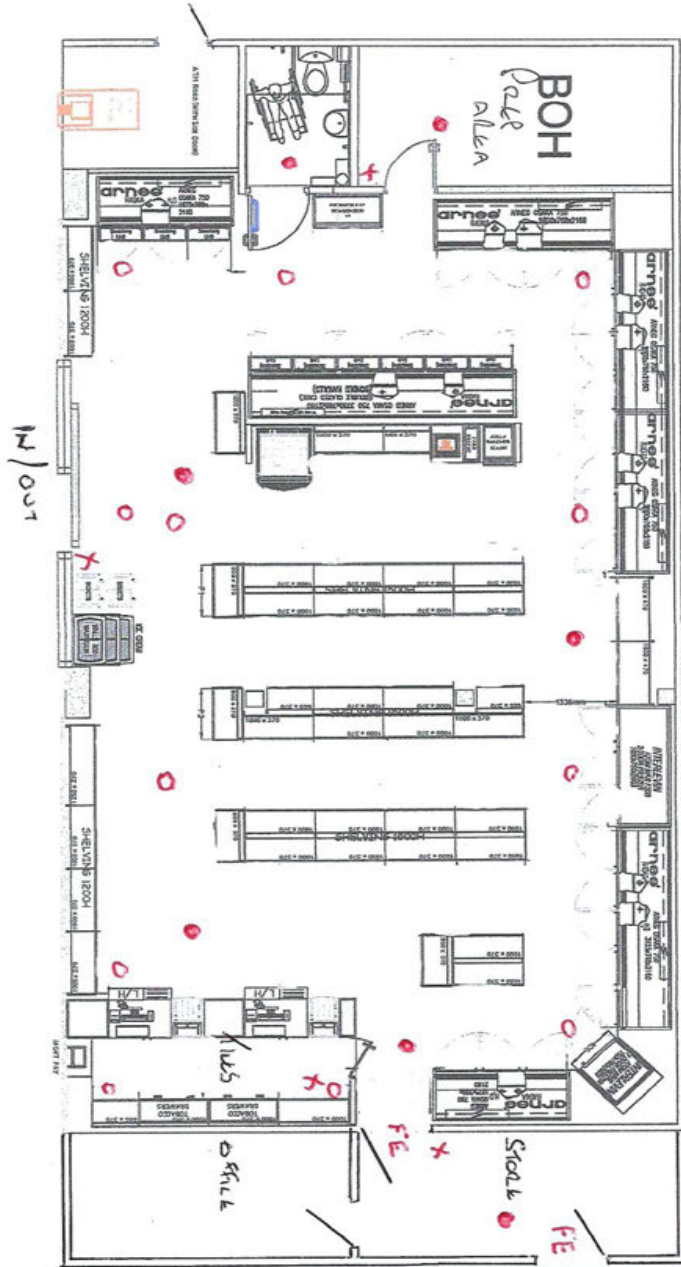

**ALCOHOL DISPLAY AND PROVISION OF LNR THROUGHOUT THE STORE  
WITHIN THE RED BORDER**

Key	
CCTV Camera	o
Extinguisher	X
Emergency Light	●
Fire Exit	FE

**From:** [REDACTED] >  
**Sent:** 05 January 2025 19:03  
**To:** LicensingUnit CCDC <LicensingUnit@cannockchasedc.gov.uk>  
**Subject:** Opposing 24-hour Licensing at Tower Garage, Brindley Rd, Hednesford

**CAUTION:** This email originated from outside of the Council. DO NOT click links or open attachments unless you recognise the sender and know the content is safe.

**PLEASE NOTE:** This email is from an infrequent correspondent.

[licensingunit@cannockchase.gov.uk](mailto:licensingunit@cannockchase.gov.uk)

FAO: Licencing Unit

To whom it may concern,  
I am writing this email to express my strong objection to the proposed 24-hour licensing of the petrol station planned at Brindley Rd, Hednesford, Cannock, WS12 4LL.  
This is located at the edge of the Cannock Chase National Landscape (formerly AONB).

My family and I are frequent users of Cannock Chase, and I am deeply concerned about the potential negative impacts that such a development could cause to the wildlife and environment.  
The continuous operation of a petrol station would firstly cause increased noise and light pollution, potentially disrupting wildlife in the vicinity.  
Secondly, increased traffic would pose a safety risk for both the wildlife and human population. The 4-way junction in which the petrol station is located is already notorious for road traffic accidents, and the 24-hour licencing would only further increase the risk. On top of this, throughout Cannock Chase, the lack of road lighting makes it hard for drivers to see wildlife, and the implementation of 24-hour licencing would only further this issue.  
Lastly, there would be an increase in anti-social behaviour with the sale of alcohol past 10pm, such as drink-driving, alcohol-induced violence and littering.

I hope that you consider the negative impacts that this proposal could have on the local area, and I would request that the licencing unit:

- Rejects the proposal for the 24-hour petrol station.
- Should the proposal go ahead, implement rules regarding the opening times and the hours in which alcohol can be sold.

I trust that you will take consideration to my concerns and act in the best interest of the local area.

Thank you,

[REDACTED]



**From:** [REDACTED] >  
**Sent:** 12 January 2025 20:35  
**To:** LicensingUnit CCDC <LicensingUnit@cannockchasedc.gov.uk>  
**Subject:** Objection to 24-Hour License Application at CONVENIENCE STORE - TOWER GARAGE

**CAUTION:** This email originated from outside of the Council. DO NOT click links or open attachments unless you recognise the sender and know the content is safe.

**PLEASE NOTE:** This email is from an infrequent correspondent.



12th January 2025

The Licensing Unit, Cannock Chase District Council, Civic Centre, Beecroft Road, Cannock, Staffordshire, WS11 1BG

Subject: Objection to 24-Hour License Application at CONVENIENCE STORE - TOWER GARAGE

To Whom It May Concern,

I am writing to formally object to the application for a 24-hour license at CONVENIENCE STORE - TOWER GARAGE, BRINDLEY ROAD, HEDNESFORD, CANNOCK, WS12 4LL.

While I understand the need for businesses to operate and contribute to the local economy, I believe granting a 24-hour license to this establishment raises significant concerns that could adversely affect the community.

#### Concerns Regarding the 24-Hour License

- **Noise Pollution**  
Extended operating hours could lead to increased noise levels during late hours, which may disturb residents' peace and disrupt their sleep patterns. This is especially concerning for families, elderly individuals, and shift workers who require adequate rest.
- **Public Safety**  
A 24-hour operation may attract larger crowds at all hours, potentially leading to an increase in anti-social behavior, loitering, and disturbances. Without appropriate measures in place, this could escalate into a safety risk for residents.
- **Traffic and Speeding Issues**  
The increased traffic to the area, especially late at night, raises concerns about road safety. There have already been issues with speeding in the vicinity, and extended operating hours could exacerbate the problem. Patrons leaving late at night might be more inclined to speed, further endangering pedestrians and other road users.
- **Impact on Residential Area**  
The establishment's location near a residential area magnifies these concerns.

ANNEX 2

Residents should not have to endure the negative effects of such an operation, including late-night disruptions and safety risks.

- Request for Action, I urge the relevant authorities to consider the following before making a decision: Conducting a comprehensive impact assessment on noise, traffic, and safety.

Implementing strict conditions if the license is granted, such as noise restrictions, increased security, and traffic-calming measures like speed bumps or speed cameras.

Limiting the operating hours to mitigate the concerns raised.

I trust you will take these concerns seriously and prioritize the well-being of the community when evaluating this application.

Thank you for your attention to this matter. Please do not hesitate to contact me at [REDACTED] or [REDACTED], if you require further clarification or input.

Yours sincerely,

**From:**

**Sent:** 13 January 2025 07:42

**To:** Development Control CCDC

**Subject:** Objection to planning application by Tower Garage Service Station Ltd.

**CAUTION:** This email originated from outside of the Council. DO NOT click links or open attachments unless you recognise the sender and know the content is safe.

**PLEASE NOTE:** This email is from an infrequent correspondent.

**NOTICE OF APPLICATION FOR A PREMISES LICENCE  
UNDER SECTION 17 OF LICENSING ACT 2003**

Notice is hereby given of an application made to Cannock Chase District Council.

**By:** TOWER GARAGE SERVICE STATION LTD

**For:** CONVENIENCE STORE - TOWER GARAGE,  
BRINDLEY ROAD, HEDNESFORD, CANNOCK, WS12 4LL

To allow the following licensable activities at the above named premises with effect from 18th January 2025:

1. Supply of alcohol (Off Sales)  
Monday to Sunday - 00.00hrs to 24.00hrs
2. Late Night Refreshment  
Monday to Sunday - 23.00hrs to 05.00hrs
3. Proposed Opening hours  
Monday to Sunday - 00.00hrs to 24.00hrs

There are enough ' licenced convenience stores and Supermarkets' within the district of Hednesford and adjoining areas, another one isn't required with ridiculous 24 hour opening hours.

There will be a detrimental environmental impact, - increased noise pollution, litter, customer parking, delivery vehicles obstructions posing a greater accident risk on a junction and roads that already have problems and safety issues highlighted by Police and Community Speedwatch, substantially higher levels of footfall during unsocial hours. Unwanted increased disturbance to local residents throughout the day and evening. There are many elderly, disabled and vulnerable adults within very close proximity of this site. They already have enough to contend without being disturbed further by an unwanted business.

I object to this application in it's entirety and seek to have it rejected and no consideration given to amendments. [REDACTED]

[REDACTED]

[REDACTED]

**From:** - [REDACTED] >  
**Sent:** 13 January 2025 09:04  
**To:** LicensingUnit CCDC <LicensingUnit@cannockchasedc.gov.uk>  
**Subject:** Opposing the proposed 24-Hour Licensing of Petrol Station at Tower Garage, Brindley Rd, Hednesford, Cannock WS12 4LL

**CAUTION:** This is an external email and has suspicious content. Please take care! Do not click links or open attachments unless you recognise the sender and know the content is safe. If in doubt contact the Service Desk

**CAUTION:** This email originated from outside of the Council. DO NOT click links or open attachments unless you recognise the sender and know the content is safe.

Dear Licensing Unit,

We are writing to express our strong opposition to the proposed 24-hour licensing of the petrol station planned at Brindley Rd, Hednesford, Cannock WS12 4LL.

As you may be aware, this Petrol Station and proposed development is situated right on the edge of Cannock Chase National Landscape, an area prized by residents, visitors, and wildlife for its tranquillity and unpolluted landscape.

The proposal represents a significant change from the existing building use and operating hours, which are currently Monday – Friday 9am – 5pm, and Saturday 9am – 1pm (closed on Sundays). The new proposed licensing, to open an off-license and run the facilities 24/7 (including the sale of alcohol at all hours) is of deep concern.

We would like to express our concerns about the potential adverse effects this proposed licensing development may have on the following areas:

**Noise Pollution:** The continuous operation is likely to result in increased noise levels from vehicles and patrons, disrupting the peace, especially during nighttime hours. The garage borders four homes, and is set at the end of a row of bungalows which houses our vulnerable elderly and disabled residents. Furthermore, situated on the edge of Cannock Chase, a designated National Landscape, it risks disturbing wildlife.

**Light Pollution:** Bright lighting necessary for a 24-hour facility could intrude into our homes, affecting sleep and overall well-being. As above, the garage borders four homes, and is set at the end of a row of bungalows housing vulnerable elderly and disabled residents.

**Safety Risks:** Increased traffic and activity during late hours may elevate the risk of accidents and pose safety concerns for residents, particularly children and the elderly. The four-way junction is already very busy and a spot known for car accidents. A 24-hour petrol station will only increase this risk.

**Increased Risk of Crime and public nuisance:** Extended operating hours for the sale of alcohol may lead to an increase in anti-social behaviour, public disturbances, alcohol-fuelled crimes, and littering – a particular concern due to the site's proximity to the Chase and its varied wildlife. Our residents regularly litter-pick at the entrance to the chase at the end of Tower Road and the area would be unable to cope with the increased litter that this licensing would bring. I have attached just a few photos of the litter we currently consistently have to clean up.

**Environmental Impact:** The constant operation raises concerns about potential fuel spills, increased emissions, and other environmental hazards. Situated on the edge of Cannock Chase National Landscape, it again poses risks to wildlife.

**Strain on Local Resources:** Continuous availability of alcohol may place an undue burden on local law enforcement and emergency services, impacting their ability to manage public safety effectively.

**Impact on the Local Community:** There are many local shops within a mile of this proposal already serving the community, none of which are 24-hour, including Rose Cottage convenience store at Broadhurst Green (0.1 miles away), One stop located at 4 Rosehill, Hednesford, Cannock WS12 4RT (0.6 miles away), and the new local Co-Op food, Pye Green (0.8 miles away). A 24/7 facility is not needed, and extending the licensing hours could aggravate problems in our area.

National and Local planning guidelines emphasise the importance of preserving residential amenity and minimising disturbances from commercial activities, along with protecting tranquil areas.

With this in mind, we strongly object to the 24-hour operation of the proposed petrol station and store.

We respectfully request that the Licensing Unit consider the following actions:

1. Reject the application for 24-hour operation of the proposed petrol station and store.
2. If the development proceeds, impose restrictions on operating hours to mitigate the impact on the community (e.g., limiting operations between 6 AM and 10 PM). This would be in keeping with similar conditions on stores within the area including Rose Cottage convenience store at Broadhurst Green (0.1 miles away), One stop located at 4 Rosehill, Hednesford, Cannock WS12 4RT (0.6 miles away), and the new local Co-Op food, Pye Green (0.8 miles away).

We trust that the Licensing Unit will give due consideration to our concerns and act in the best interest of the community.

Sincerely,

[REDACTED]  
[REDACTED]  
[REDACTED]  
[REDACTED]  
[REDACTED]

ANNEX 2

**From:**

**Sent:** 17 January 2025 16:07

**To:** Scot Kearney

**Subject:** Re: Premises Licence Application - Tower Garage, Brindley Rd, Hednesford, Cannock WS12 4LL

Scot,

**Premises Licence Application - Tower Garage, Rd, Hednesford, Cannock WS12 4LL**

**Ref: 110159**

I would like to object to the above application as I feel that a 24 hour license will encourage people to turn up by car or on foot in the middle of the night and cause excessive noise and disturbance to the local residents many of whom are elderly. Litter will also be a more pronounced problem as the location is at a high point in the area which is very windy and very close to Cannock Chase.

There is also a greater chance of crime and disorder as well as anti social behaviour with a sharp influx of new people into this quiet part of Hednesford. I would ask the committee to reject this proposal.

Regards

**Hednesford Pye Green Ward**

Sent from [Outlook for iOS](#)

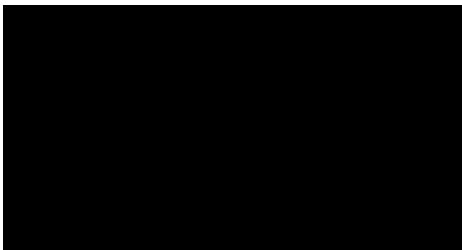

From: <[REDACTED]>  
Date: Sun, 5 Jan 2025, 18:44  
Subject: Opposing the proposed 24-Hour Licensing of Petrol Station at Tower Garage, Brindley Rd, Hednesford, Cannock WS12 4LL  
To: <[licensingunit@cannockchase.gov.uk](mailto:licensingunit@cannockchase.gov.uk)>

Dear Licensing Unit,

We are writing to express our strong opposition to the proposed 24-hour licensing of the petrol station planned at Brindley Rd, Hednesford, Cannock WS12 4LL, situated on the edge of Cannock Chase, a designated National Landscape.

Areas of Outstanding Natural Beauty were re-branded as National Landscapes in 2023. National Landscapes (along with National Parks) are the nation's finest landscapes, whose breath-taking beauty is so precious that they are protected in the national interest. There are just 34 National Landscapes in England, five in Wales and eight in Northern Ireland. Cannock Chase was designated an AONB in 1958 because of its beautiful landscape, its wildlife and its history.

As a frequent user of Cannock Chase, we are deeply concerned about the potential adverse effects this development may have on the following areas:

**Noise Pollution:** The continuous operation is likely to result in increased noise levels from vehicles and patrons, disrupting the peace, especially during nighttime hours. Situated on the edge of Cannock Chase, a designated National Landscape, it risks disturbing wildlife.

**Environmental Impact:** The constant operation raises concerns about potential fuel spills, increased emissions, and other environmental hazards. Situated on the edge of Cannock Chase National Landscape, it again poses risks to wildlife.

**Safety Risks:** Increased traffic and activity during late hours may elevate the risk of accidents and pose safety concerns for a variety of wildlife, including deer. The fourway junction is already very busy and a spot known for accidents. A 24-hour facility will only increase this risk.

**Increased Risk of Crime and public nuisance:** Extended operating hours for the sale of alcohol could aggravate problems in the area including dangerous driving, antisocial behaviour, public disturbances, alcohol-fuelled crimes, and littering a particular concern due to the sites proximity to the Chase and its varied wildlife.

Studies have shown that 24-hour petrol stations can lead to increased noise and light pollution. The light pollution will have a direct effect on Cannock Chase National Landscape's nature and its abundance of wildlife, next to which this proposal is situated.



ANNEX 3

National and Local planning guidelines emphasise the importance of preserving residential amenity and minimising disturbances from commercial activities, along with protecting tranquil areas. Cannock Chase is prized by residents, visitors, and wildlife for its tranquillity and unpolluted landscape.

Call to Action: We respectfully request that the Licensing Unit consider the following actions:

1. Reject the application for 24-hour operation of the proposed petrol station and store.
2. If the development proceeds, impose restrictions on operating hours to mitigate the impact on the community (e.g., limiting operations between 6 AM and 10 PM). This would be in keeping with similar conditions on stores within the area including Rose Cottage convenience store at Broadhurst Green (0.1 miles away), One stop located at 4 Rosehill, Hednesford, Cannock WS12 4RT (0.6 miles away), and the new local Co-Op food, Pye Green (0.8 miles away).

We trust that the Licensing Unit will give due consideration to our concerns and act in the best interest of the community.

Sincerely,



①

12 January 2025

C C D C

AF 15 JAN 2025

Dear Licensing Unit.

We live at the above <sup>POST ROOM</sup> address which is adjacent to the Tower Garage, Petrol Station. We would like to add a bit more information to the accompanying letter.

"Increased Risk of Crime and Public Nuisance"

In front of the Tower Garage there is a very low wall which is ideal for sitting on. If alcohol is available 24/7, youths would be gathering here at night time to drink as would the 'boy racers'. There would be shouting, swearing, running on gardens, urinating on the gardens or up the fencing.

The residents in Bundley Road which are all QAPs would find it

② very intimidating if they <sup>had to</sup> walk past these gathering of mainly young men drinking alcohol.  
If alcohol is available 24/7 when will we be able to rest and get any sleep with all the nuisance going on outside our premises.

Cannock Chase, on AONB and alcohol available 24/7, not a good thing, except for the people selling the alcohol.

This letter opposing the 24 hour licensing for CONVENIENCE STORE, TOWER GARAGE, BRINDLEY ROAD, HEDNESFORD, CANNOCK, STAFFS NS12 4LL, to be read along with the main letter of opposition.  
Thank you.

Mine Sincerely  

CCDC  
 16 JAN 2025  
 POST ROOM



16<sup>th</sup> January 2024

CANNOCK CHASE COUNCIL  
 ENVIRONMENTAL HEALTH

16 JAN 2025

PASSED TO

To  
 Licensing Unit  
 CCDC  
 WS11 1BG

Dear Sirs

I am writing to express my concerns over the planning application for a 24 hour licence at Tames Garage, Pye Green Road WS12 4LL.

I am sure that having a shop at the petrol station will be of potential benefit to some, especially the less mobile in the burglands. However, the dangers of this proposal for many residents will outweigh the benefits of serving alcohol to a few.

In the summer, less desirable characters will be more easily able to purchase alcohol to consume on Cannock Chase natural landscape, leaving litter, terrorising others trying to use the park with their families, and massively increasing the risk of fire. Does CCDC have a response to this?

Also it is a tricky junction, there are regular bus services, and more stop/start traffic would

worsen the junction.

I would suggest that the committee would reduce the proposed hours to 6am - 10pm - as the local co-op, Spar + other small shops in the area, which would be fair and reasonable.

Thank you for considering our views

Yours faithfully

[Redacted signature]

[Redacted address]

***Opposing 24 hour licensing at what was Tower Garage, Brindley Rd, Hednesford, Cannock WS12 4LL***

To:

Licensing Unit  
Cannock Chase District Council  
Civic Centre  
Beecroft Road  
Cannock  
Staffordshire  
WS11 1BG  
United Kingdom

Subject:

**Opposing the proposed 24-Hour Licensing of Petrol Station at Tower Garage,  
Brindley Rd, Hednesford, Cannock WS12 4LL**

Dear Licensing Unit,

We are writing to express our strong opposition to the proposed 24-hour licensing of the petrol station planned at Brindley Rd, Hednesford, Cannock WS12 4LL. Our community is deeply concerned about the potential adverse effects this development may have on the following areas:

**Noise Pollution:** The continuous operation is likely to result in increased noise levels from vehicles and patrons, disrupting the peace, especially during nighttime hours. Furthermore, situated on the edge of Cannock Chase, a designated National Landscape, it risks disturbing wildlife.

**Light Pollution:** Bright lighting necessary for a 24-hour facility could intrude into our homes, affecting sleep and overall well-being.

**Safety Risks:** Increased traffic and activity during late hours may elevate the risk of accidents and pose safety concerns for residents, particularly children and the elderly. The four-way junction is already very busy and a spot known for car accidents. A 24-hour petrol station will only increase this risk.

**Environmental Impact:** The constant operation raises concerns about potential fuel spills, increased emissions, and other environmental hazards. Situated on the edge of Cannock Chase National Landscape, it again poses risks to wildlife.

**Increased Risk of Crime and public nuisance:** Extended operating hours for the sale of alcohol may lead to an increase in anti-social behaviour, public disturbances, alcohol-fuelled crimes, and littering – a particular concern due to the sites proximity to the Chase and its varied wildlife.

***Opposing 24 hour licensing at what was Tower Garage, Brindley Rd, Hednesford, Cannock WS12 4LL***

**Strain on Local Resources:** Continuous availability of alcohol may place an undue burden on local law enforcement and emergency services, impacting their ability to manage public safety effectively.

**Impact on the Local Community:** There are many local shops within a mile of this proposal already serving the community, none of which are 24-hour. This is not needed, and extending the licensing hours could aggravate problems in the area including litter and anti-social behaviour.

Studies have shown that 24-hour petrol stations can lead to increased noise and light pollution in residential areas. Further, the light pollution will have a direct effect on Cannock Chase National Landscape's nature and its abundance of wildlife, next to which this proposal is situated.

National and Local planning guidelines emphasise the importance of preserving residential amenity and minimising disturbances from commercial activities, along with protecting tranquil areas. Cannock Chase is prized by residents and wildlife for its tranquillity and unpolluted landscape.

**Call to Action:**

We respectfully request that the Licensing Unit consider the following actions:

1. Reject the application for 24-hour operation of the proposed petrol station and store.
2. If the development proceeds, impose restrictions on operating hours to mitigate the impact on the community (e.g., limiting operations between 6 AM and 10 PM). This would be in keeping with similar conditions on stores within the area including Rose Cottage convenience store at Broadhurst Green (0.1 miles away), One stop located at 4 Rosehill, Hednesford, Cannock WS12 4RT (0.6 miles away), and the new local Co-Op food, Pye Green (0.8 miles away).

We trust that the Licensing Unit will give due consideration to our concerns and act in the best interest of the community.

Sincerely,

**Name:**

**Address:**

(To T22870)

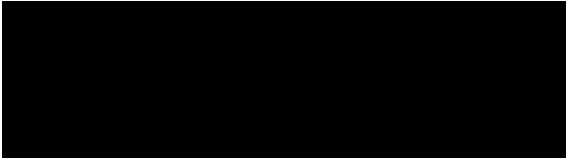

PETITION TO STOP THE OPENING OF [REDACTED] AT TOWER GARAGE, BRINDLEY ROAD, HEDNESFORD, CANNOCK. WS12 4LL.

We, the undersigned, oppose the opening of [REDACTED] at the above address as we have three local shops within a mile radius. [REDACTED] it will create noise pollution and high amounts of traffic, which can cause more accidents at an already busy junction.



Name Printed	Contact Information	Signature
Charles	[REDACTED]	[REDACTED]
Laura	[REDACTED]	[REDACTED]
Phil	[REDACTED]	[REDACTED]
Cam	[REDACTED]	[REDACTED]
Helen	[REDACTED]	[REDACTED]
IA	[REDACTED]	[REDACTED]
Sam	[REDACTED]	[REDACTED]
FG	[REDACTED]	[REDACTED]
R	[REDACTED]	[REDACTED]
C.G	[REDACTED]	[REDACTED]
Ray	[REDACTED]	[REDACTED]
R	[REDACTED]	[REDACTED]
Debi	[REDACTED]	[REDACTED]
Man	[REDACTED]	[REDACTED]
Case	[REDACTED]	[REDACTED]
B-T	[REDACTED]	[REDACTED]
S. J	[REDACTED]	[REDACTED]
Sandra	[REDACTED]	[REDACTED]
Jos	[REDACTED]	[REDACTED]
Chloe	[REDACTED]	[REDACTED]
Paul	[REDACTED]	[REDACTED]
D-	[REDACTED]	[REDACTED]
J.	[REDACTED]	[REDACTED]
H.	[REDACTED]	[REDACTED]
Y	[REDACTED]	[REDACTED]
Y	[REDACTED]	[REDACTED]
C.S	[REDACTED]	[REDACTED]
N.	[REDACTED]	[REDACTED]
S.W	[REDACTED]	[REDACTED]
IEE	[REDACTED]	[REDACTED]
IEE	[REDACTED]	[REDACTED]
John	[REDACTED]	[REDACTED]
Amr.	[REDACTED]	[REDACTED]
Kare	[REDACTED]	[REDACTED]
Stuen	[REDACTED]	[REDACTED]

35

35



Name Printed	Contact Information	Signature
B-		
N H		
S		
M. O		
J P		
M.M		
A-W		
M. BA		
JAH		
Nao		
Joe		
U B		
Gene		
REED		
Paul		
DAVE		
J.		
A A		
T Mac		
CAR		
S		
R		
M		
K		
T		
A		
S.M		
m. J		
K SH		
Dave		
Raven		
Laura		
Rache		
Michael		
Lisa		
Abigail		
Andy		
Matt		
Douglas		
Randi		
Stuart		
Katie		
Nayan		
Ellen		
Mary		

45

45

Name Printed	Contact Information	Signature
Tom G		
Demi		
george		
Rach		
Garet		
Adam		
Reyan		
JOHN		
G. ABS		
L. W. H.		
S. P. R.		
LA		
Conno		
LEE		
M. Sim		
E. M. O. V.		
A. Simu		
D. SIM		
I. SIM		
S. M.		
Ma		
J. Ma		
D. A.		
D. A.		
Kama		
Mann		
J. N. B.		
C. N. B.		
M. B.		
M. S.		
N. M.		
C. O. V.		
MALC		
Alan		
John		
John		
John		
John		
N. K.		
K. A.		
K. A.		
W. A.		
Jeff		
M. C.		

45

45

Name Printed	Contact Information	Signature
JUAN		
JASO		
R.J.		
B.P.		
M. S.		
J. J.		
S. C.		
A. H.		
C. T.		
A. W.		
D. G.		
M. C.		
C. M.		
V. E.		
G. L.		
L. R.		
W. J.		
Ross		
Hanna		
C. M.		
M. J.		
Mail		
A. G.		
P. D.		
B. W.		
M. W.		
S. A.		
P. W.		
K. D.		
L. G.		
S. W.		
P. R.		
P. J.		
T. F.		
Angel		
ETI		
MAIZY		
NIR		
M. S.		
MRS		
J. J.		
D. M.		
P. J.		
M. J.		
K.		

45

45

Name Printed	Contact Information	Signature
Ellie		
I Eddy		
<del>Sam</del>		
Daniel		
S. Long		
E. Jones		
R. Smith		
M. Brown		
E. O'Connell		
L. Adams		
J. Smith		
R. McCoy		
B. White		
B. Young		
D. King		
J. Martin		
L. Baker		
J. Doe		
<del>W. Lee</del>		
<del>W. Lee</del>		
C. H.		
Kate		
R. Snow		
K. Snow		
D. Snow		
T. White		
P. Edwards		
H. Miller		
L. White		
M.		
M. G.		
N. P.		
D. K.		
P. B.		
A. B.		
<del>S.</del>		
R. C.		
Char		
Wendy		
Debbie		
JUNE		
CHRIS		
EDEN		
PAULINE		
Clare		

45

45

Name Printed	Contact Information	Signature
Katie		
Shae		
Share		
Brian		
GARY		
Reed		
Adri		
Madri		
E. 200		
Dumb		
Joan		
MICH		
Bill		
Deu		
A. J.		
A. W.		
Shy		
A		
Jerry		
Anna		
C. P.		
200		
200		
C. P.		
A. L.		
A. L.		
Jessie		
Deu		
M.		
A. P.		
S. Re		
Tily		
Alire		
Sime		
Nara		
Jose		
C		
J. Re		
Leight		
B. L.		
Bony		
T. D.		
McL		
Alan		
Sam		

45

5

u n

Name Printed	Contact Information	Signature
John		
Mica		
P. Pa		
M. Miller		
R. No		
R. R		
S. R		
A. Geo		
B. M. H		
Y. J		
J. J. J		
Kath		
Steve		
David		
Jam		
mick		
Ther		
Stev		
W. A. P		
Char lotte		
Colin		
JASON		
Mark		
NATHAN		
<del>SEAN</del>		
V. G		
Car		
DAVID		
SAM		
J. D.		
B. Co		
M. W		
V. H. S		
JASON		
LEE		
Shona		
Joch		
R. H		
A. Thom		
C. G		
S. G		
A. G		
O. M		
M. G		
N. B		

45

Name Printed	Contact Information	Signature
Ben		
CHRIST		
Mich		
Riley		
Dave		
Ange		
Bob		
Carl		
Chris		
John		
Joe		
HI CA		
J		
P. BEC		
S. HIC		
P. Ho		
R. HAN		
J. M.		
R. M.		
D. M.		
blake		
J.		
L. W.		
V.		
T. T.		
N. I.		
T. J.		
A. W.		
C. J.		
B. J.		
J. S.		
KAT		
NIG		
CO		
Kevin		
key		
C. W.		
Sta		
M.		
Rob		
KAR		
STEP		
TOM		
ADAM		

45

45

Name Printed	Contact Information	Signature
AM		
CHRISTE		
Joy		
Mei		
KIMBRLE		
MR MER		
PEBBIE		
CHIE		
Ben W		
Matthew		
CHRIS		
AN		
REBECCA		
Laura		
JOSH		
JAUD		
FREY		
PAM		
CLA		
GREG		
AMY		
GYNNE		
CAT		
Jan		
STEAT		
JAMIN		
AMIE		
VIKKI		
LAUREN		
ROSE D		
SOMER		
Charles		
Margie		
Marina		
Kendal		
P. H		
LISA		
Kyle		
Greg		
D. Star		
M. T		
J. SWA		
R. S		
CARLI		
SHANE		

45



Name Printed	Contact Information	Signature
A S		
W. W		
E. I		
NEIL		
D GR		
M. S. H		
W. G		
W. G		
Josh		
Don		
Ken G		
P. T		
J. B		
V. B		
is re		
R. G		
Chad		
FAW		
balz		
J. ca		
MA		
TS. STA		
JLWS		
DAVE		
HEL		
Beck		
ANITA		
Jimmi		
Jack		
Melis		
Ben		
S. A		
R. M		
T. Hop		
K. Ba		
T. Cla		
EMMO		
J. M		
N. G		
DAVE		
Mill		
TARA		
JULIE		
TIFFA		
Saul		

Name Printed	Contact Information
Kevin	[REDACTED]
S. [REDACTED]	[REDACTED]
KEVIN	[REDACTED]
Katy	[REDACTED]
CHAND	[REDACTED]
Joy T	[REDACTED]
Olivia	[REDACTED]
Ryan	[REDACTED]
PHILIP	[REDACTED]
EMILY	[REDACTED]
Mark	[REDACTED]
Mark	[REDACTED]
Jin	[REDACTED]
[REDACTED]	[REDACTED]
Kerr	[REDACTED]
Alan	[REDACTED]
STEVE	[REDACTED]
RYAN	[REDACTED]
CHRIS	[REDACTED]
P. [REDACTED]	[REDACTED]
STUAR	[REDACTED]
M. [REDACTED]	[REDACTED]
S. [REDACTED]	[REDACTED]
stace	[REDACTED]
STUAR	[REDACTED]
Nick	[REDACTED]
Jacobs	[REDACTED]
Ann	[REDACTED]
DONNA	[REDACTED]
JAM	[REDACTED]
KRIST	[REDACTED]
Tom	[REDACTED]
NIC	[REDACTED]
LEAM	[REDACTED]
Ken	[REDACTED]
Kerr	[REDACTED]
ERIC	[REDACTED]
D. CAL	[REDACTED]
Lynn	[REDACTED]
[REDACTED]	[REDACTED]
M	[REDACTED]
ACCA	[REDACTED]
C. [REDACTED]	[REDACTED]
VERASO	[REDACTED]
MARK	[REDACTED]

Name Printed	Contact Information	Signature
MARIA		
Charli		
CHARLI		
DORM		
Tana		
ELIZB		
Q em		
NICOLA		
SIAN		
Kiera		
JES		
EMM		
JAC		
Lucy		
Christa		
Amam		
CLARE		
Adria		
Nicola		
Sam		
E LE		
AMAZ		
H EU		
KIS		
L CH		
Harvey		
Sarah		
RYAN		
WIDE		
Percy		
Calu		
PHIL		
EMEN		
Deon		
T. CO		
LEI		
Brox		
Chlo		
MA		
A. Co		
adria		
D. G		
G. Lind		
W		

Name Printed	Contact Information	Signature
D PHILIP		
W-D		
STELLA		
RHI		
NICOLE		
C. TA		
A MA		
J MOR		
Carl		
M. Pod		
Col		
C SCH		
K REST		
S JO		
Zoe		
J T		
F		
P. CO		
N GR		
Chris		
<del>42</del>		
G. sma		
K. CO		
A. tu		
Tamm		
Alan		
SIAN		
JOER		
Eliza		
A. ma		
Rachel		
RICH		
N. B		
T. B		
BUSS		
JENNI		
Eliza		
CAT		
PHILIP		
JAC		
RHI		
Rox		
LEEM		

Name Printed	Contact Information
Rocco	[REDACTED]
Logan	[REDACTED]
P. [unclear]	[REDACTED]
D. [unclear]	[REDACTED]
ROBERT	[REDACTED]
MRS H	[REDACTED]
Chelsea	[REDACTED]
Chloe	[REDACTED]
M. [unclear]	[REDACTED]
N. [unclear]	[REDACTED]
ESME	[REDACTED]
SARA	[REDACTED]
Roxi	[REDACTED]
Key	[REDACTED]
ARIAN	[REDACTED]
Ashley	[REDACTED]
CLA	[REDACTED]
ALEX	[REDACTED]
N. [unclear]	[REDACTED]
CRAM	[REDACTED]
STEVEN	[REDACTED]
Sam	[REDACTED]
CAI	[REDACTED]
MON	[REDACTED]
Arlean	[REDACTED]
C. [unclear]	[REDACTED]
Chad	[REDACTED]
Mark	[REDACTED]
DAVE	[REDACTED]
Merish	[REDACTED]
RSU	[REDACTED]
Merish	[REDACTED]
A. [unclear]	[REDACTED]
Wibe Gu	[REDACTED]
LAW	[REDACTED]
KAI	[REDACTED]
GAIL	[REDACTED]
KEV	[REDACTED]
LUKE	[REDACTED]
M. [unclear]	[REDACTED]
Banca	[REDACTED]
AMEL	[REDACTED]
T. [unclear]	[REDACTED]
BRAD	[REDACTED]
JOHN	[REDACTED]

(15)

Name Printed	Contact Information	Signature
C. Sch		
Sto		
BRAD		
Kristin		
SARA		
Kat		
Emily		
Paul		
LAURA		
LUKE		
Clem		
JOE		
CURTIS		
EMILY		
R. J		
JAC		
RH		
LAURA		
NIC		
Nicole		
D. K		
Joe		
Karen		
Matt		
AMAR		
LYND		
BARBARA		
SARA		
TOM		
NEIL		
EMILY		
TRAVIS		
PAUL		
MEGAN		
M. J		
O. Burr		
S. C		
JANIS		
Gemma		
Beth Ann		
Laura		
Roxie		
ROBE		
Loi		
JAC		

Name Printed	Contact Information	Signature
Meg		
JOHN		
Am		
Key		
V PR		
Paige		
ARRA		
PACI		
Elisha		
MARY		
Pear		
CHRIS		
EMMA		
KEVIN		
STUART		
James		
CHIEF		
John		
Jaco		
AS		
Lvds		
Lya		
Jan		
CLAIRE		
Co		
deya		
PHIL		
Devo		
ANDR		
GLEN		
NICK		
CA		
PHIL		
ANDR		
Arlora		
LI		
J. S		
A CO		
Scott		
LYN		
ARM		
Jenni		
betin		
Laura		
mag		

TOTAL  
730  
160  
890

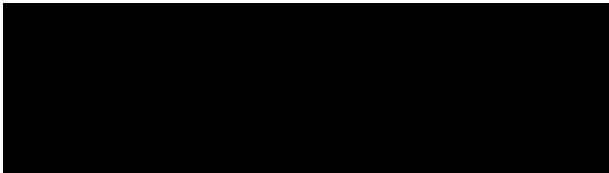

Name Printed	Contract Reference	Signature
M		
Kenn		
JUN		
Aligo		
VIZI		
Amoss		
U		
Kouou		
Bocho		
McCa		
D-L		
JANIE		
Arree		
Jaco		
WHIT		
Bleu		
NIS		
L. St		
Luck		
Tamm		
Sam		
Ma		
H. Ni		
DAWA		
DEBB		
M. S		
Karab		
TPL		
Ra		
Me		
Som		
Mi		
Kata		
Stair		
Hon		
Lua		
Som		
MEB		
ADAM		
STR		
Ros		
Blo		
Kor		
DAB		
JOHN		

115



Name Printed	Contact Information	Signature
SAM		
LAURE		
R H		
Olivia		
Ann		
Trac		
lu		
Arb		
Sara		
Ph		
Jac		
Har		
CAN		
GER		
Yvo		
SM		
Kayla		
Kim		
Ale		
M		
Reb		
MC		
LJ		
Ta		
Nic		
ST		
Ke		
K.		
SHA		
EV		
L		
Ke		
Ke		
Co		
A S		
AL		
SE		
Trac		
mid		
Par		
Tin		
me		
Bo		
NAY		
Alic		

Name Printed	Contact Information	Signature
Kelly		
A L A		
HANNAH		
Kris		
MOZIS		
Hele		
Hele		
Jess		
ALAN		
Lea		
Oliver		
JAM		
BURK		
Abi		
ARA		
Juan		
Bern		
Kath		
Fanny		
KARA		
SHERA		
CO		
JES		
DAB		
Grma		
GRIM		
CARIE		
Ma		
Matil		
MC		
Tina		
Jamie		
CR		
LUCEY		
NEW		
J.C.C.		
ARTHUR		
HEIL		
Jon		
GILL		
DAB		
RILEY		
ANINI		
SHEL		
RICHIE		

45





Name Printed	Contact Information
Tom	[Redacted]
PHI	[Redacted]
HAR	[Redacted]
SAR	[Redacted]
JAS	[Redacted]
mick	[Redacted]
Em	[Redacted]
Em	[Redacted]
Mark	[Redacted]
ma	[Redacted]
Gaz	[Redacted]
Michell	[Redacted]
HOLAN	[Redacted]
CORR	[Redacted]
Igre	[Redacted]
W JS	[Redacted]
S. fu	[Redacted]
Dean	[Redacted]
Nick	[Redacted]
Mick	[Redacted]
HA	[Redacted]
MEAL	[Redacted]
JAM	[Redacted]
SHAZ	[Redacted]
Tom	[Redacted]
Phil	[Redacted]
Cathy	[Redacted]
Mark	[Redacted]
Sarah	[Redacted]
A. Hill	[Redacted]
Ann	[Redacted]
Deb.	[Redacted]
Mark	[Redacted]
Morgan	[Redacted]
Diana	[Redacted]
DAVID	[Redacted]
Danna	[Redacted]
Kevin	[Redacted]
Diana	[Redacted]
ELARIE	[Redacted]
KEY	[Redacted]
K ST	[Redacted]
T BA	[Redacted]
M BA	[Redacted]
D DR	[Redacted]

Name Printed	Contact Information	Signature
Reed		
H		
Ben		
Anita		
Lisa		
ALLS		
END		
Nath		
BSc		
KIP		
L.S.		
P.D.		
Ke		
J.		
LO		
Al		
ADA		
mik		
Kauf		
Dor		
SH		
V. G.		
R.		
J.P.		
Dam		
K.P.		
V.		
Kath		
And		
MC		
Tas		
Pen		
S.G.		
F.		
S.		
Reed		
Edward		
Kauf		
Lee		
Talk		
H.		
H.B.		

